

1	2	3	4	5	6
REV 0	DESCRIPTION FIRST EDITION	ECN NO N/A	NAME Liu	DATE 2021-04-15	 ALL PARTS MUST MEET TO RoHS REQUIREMENTS

REMARKS:
 1.ADDS SIZE: 7.4mm
 2.CONTACT PIN TO SOLDER
 3.FERRULE TO SOLDER

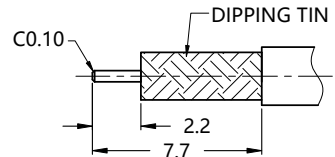

RECOMMENDED CABLE STRIPPING DIM'S

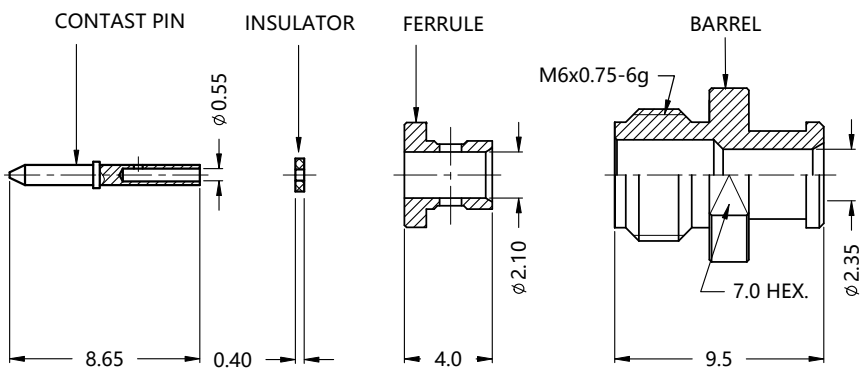
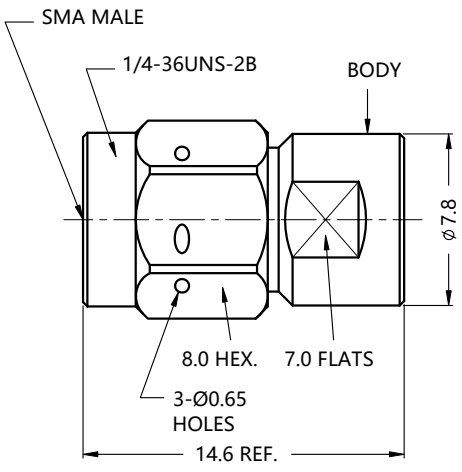

MATERIALS AND PLATING		UNIT: MICRO-INCHES	ELECTRICAL CHARACTERISTICS	
BODY/SHELL	STAINLESS STEEL 303Cu	PASSIVATION	IMPEDANCE	50 Ω
CONTACT PIN	Be-Cu C17300	GOLD 50 u"/NICKEL/COPPER	VOLTAGE RATING	N/A
INSULATOR	PEI/PTFE ASTM-D-1710	N/A	FREQUENCY RANGE	DC ~ 26.5 GHz
FERRULE	BRASS C3604	GOLD 10 u"/NICKEL/COPPER	DIELECTRIC WITHSTANDING VOLTAGE	>750 V
BARREL	STAINLESS STEEL 303Cu	PASSIVATION	CONTACT RESISTANCE	CENTER CONTACT <3.0 mΩ
GASKET	SILICONE	RED		OUTER CONTACT <2.0 mΩ
			INSULATION RESISTANCE	>5000 MΩ
			INSERTION LOSS	<0.1√F(GHz) dB
			RF- LEAKAGE	N/A
			VSWR	<1.30
			3RD INTERMODULATION	N/A

MECHANICAL CHARACTERISTICS	
FORCE TO ENGAGE AND DISENGAGE	N/A
CENTER CONTACT RETENTION FORCE	N/A
RECOMMENDED COUPLING TORQUE	7~10 in-lbs
COUPLING NUT RETENTION FORCE	> 60 lbs
DURABILITY	>500 cycles

ENVIRONMENTAL CHARACTERISTICS	
TEMPERATURE RANGE	-40 °C~+125 °C

***CUSTOMER OUTLINE DRAWING**

UNLESS OTHERWISE SPECIFIED:
 1) C0.15 MAX;
 2) REMOVE ALL BURRS;
 3) SURFACE ROUGHNESS : Ra1.6;
 4) UNITS:mm;
 5) DIMENSIONS TOLERANCES
 DECIMALS .x ±0.3 .xx ±0.2 .xxx±0.1
 ANGLES ±5°

THIRD ANGLE PROJECTION		 TITLE: SMA MALE S/T SOLDER FOR HF-090 CABLE,50Ω DRAWING NO: 5MAM15S-A570-001
APPROVED:	CUSTOMER P/N:	
CHECKED:	SCALE: 3:1	
DRAWING:	DATE: 2021-04-15	
COMPANY WEBSITE: www.slkcorp.com		

CUSTOMER OUTLINE DRAWING